

PLAN OF SUBDIVISION

Plan Number
PS 713424T

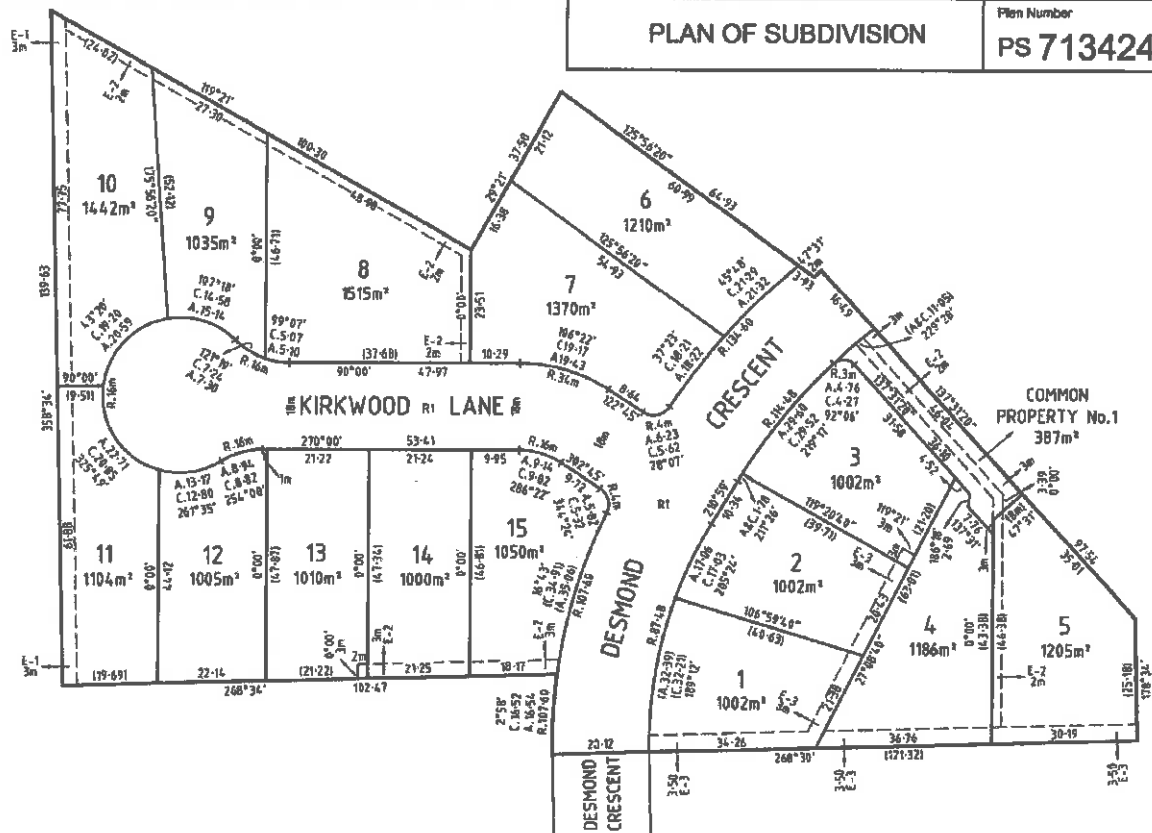

Millar | Merrigan

Land Development Consultants

18(2) 0120 9500 R 0013134 0011
www.millarandmerrigan.com.au
millar@millerandmerrigan.com.au
181 00 0000 00 00 00 00 00

Millar & Merrigan Pty Ltd ACN 009 341 080
18(2) 0120 9500 00 00 00 00 00
Registered 150 Commercial Road, Newell 3900
Mail PO Box 977 Ouyen, Victoria 3705

ORIGINAL
SCALE

1:750

SCALE



LENGTHS ARE IN METRES

LICENSED SURVEYOR G. J. LADNER

SIGNATURE

REF 15146S1

DIGITALLY SIGNED

VERSION 8

Sheet 2

ORIGINAL SHEET SIZE A3